

Montagehandleiding dakraam rolgordijn

Rollux

1: Benodigheden

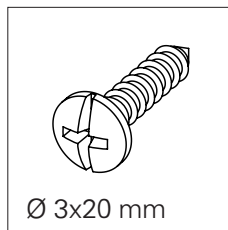
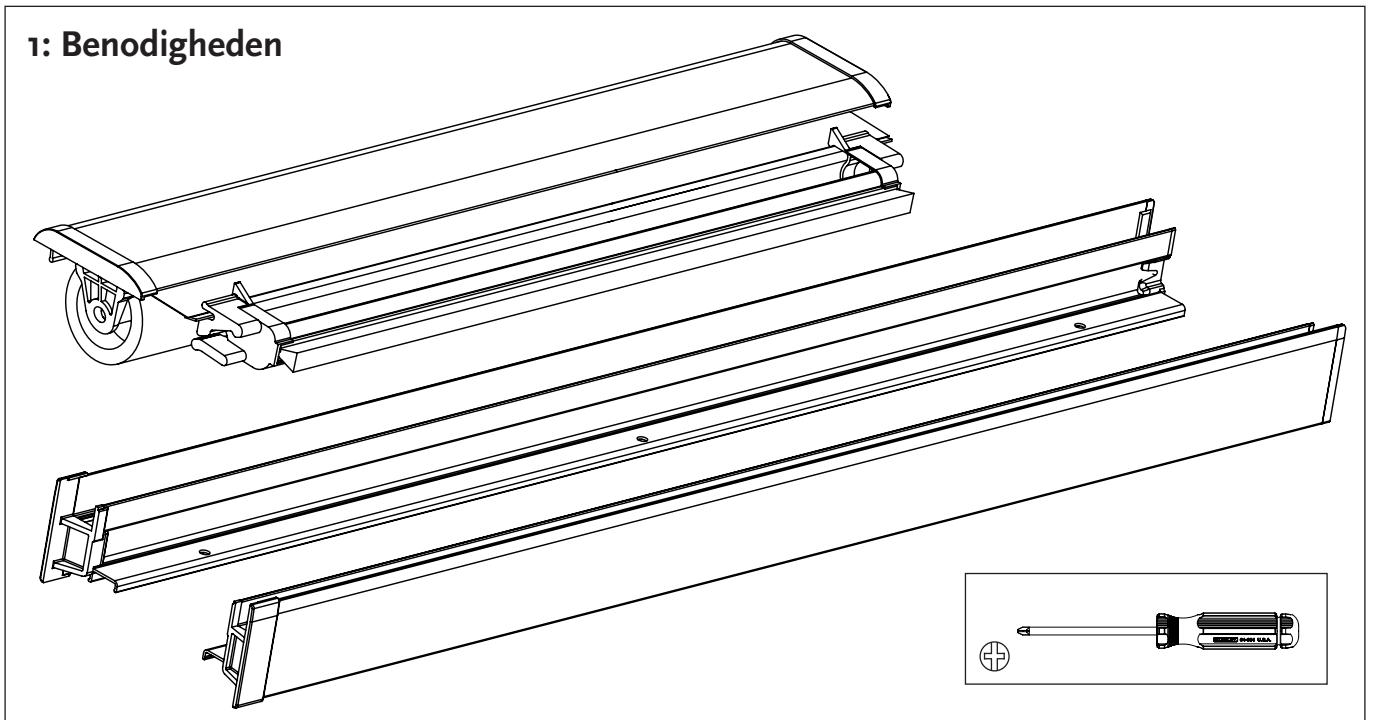

Ø 3x20 mm

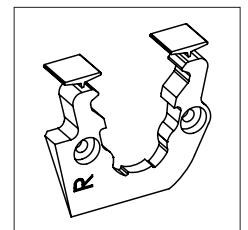
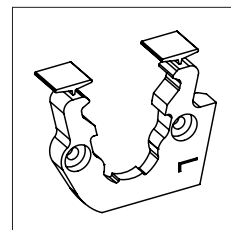

2: Monteren bevestigingssteun

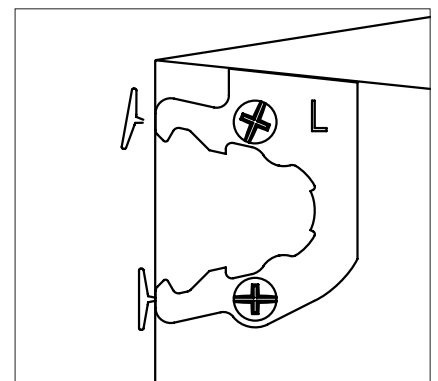
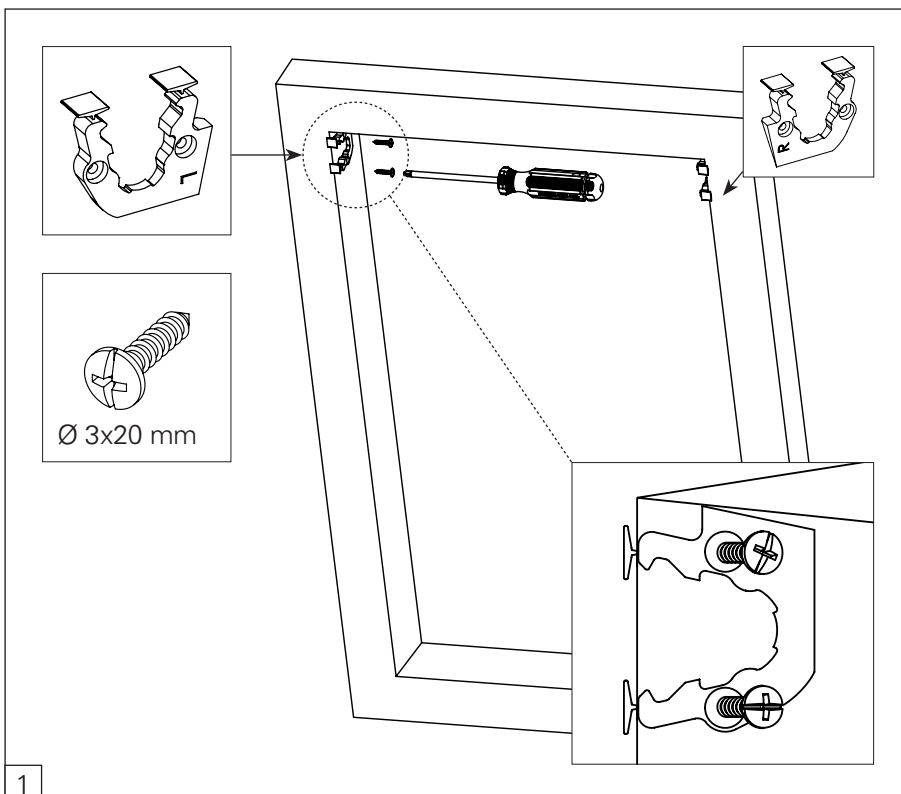

Positioneer lipjes afbreken (2x)

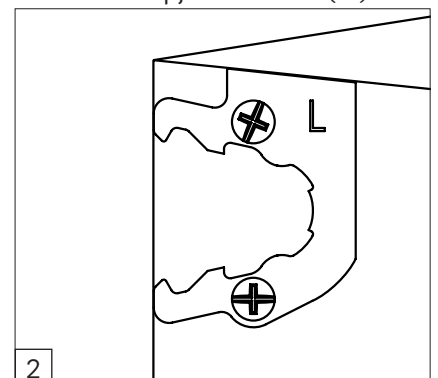

1

2

3: Monteren cassette

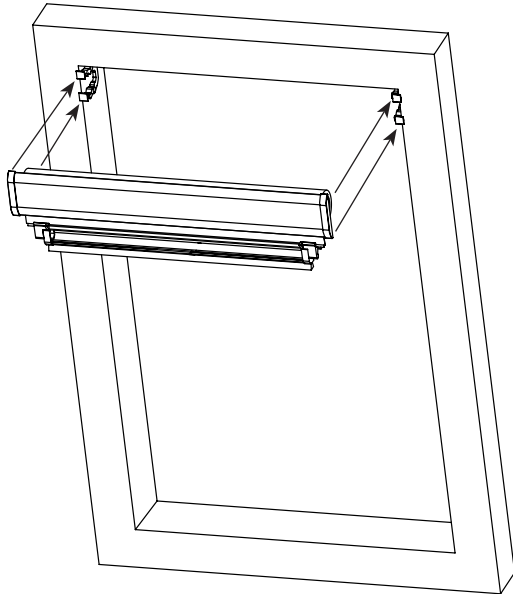

3

4: Positioneren zijgeleidingsprofiel

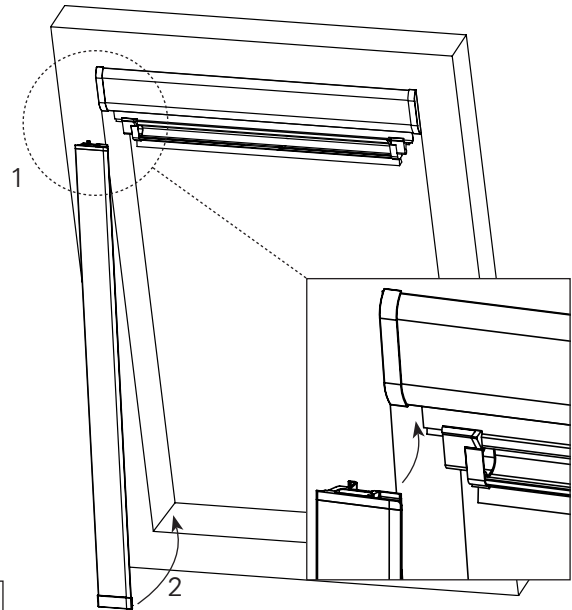

4

5: Bevestigen zijgeleidingsprofiel

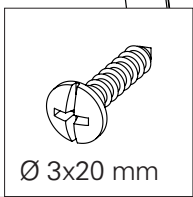
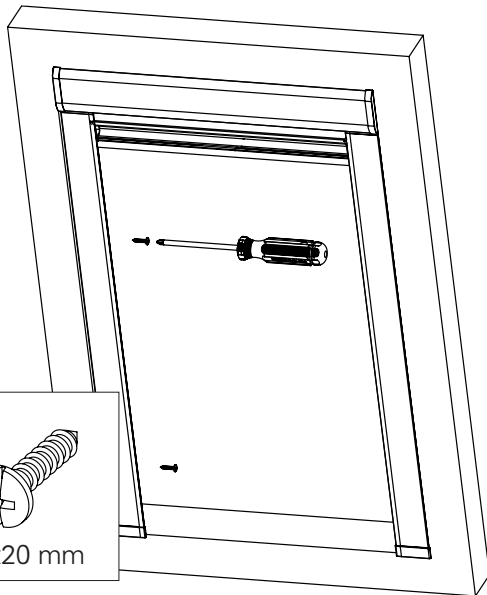

5

6: Klaar voor gebruik

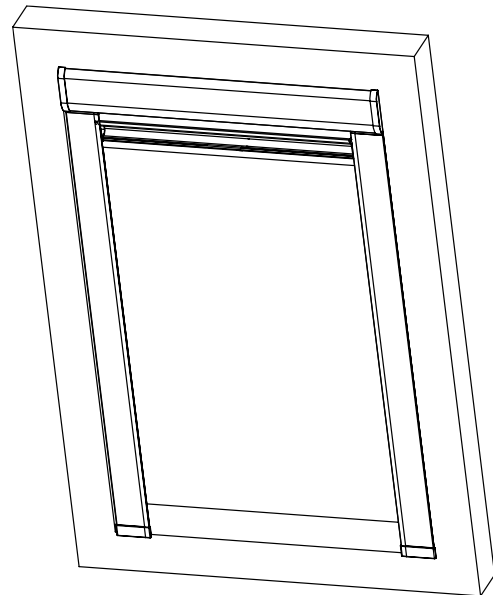

6

7: Bediening

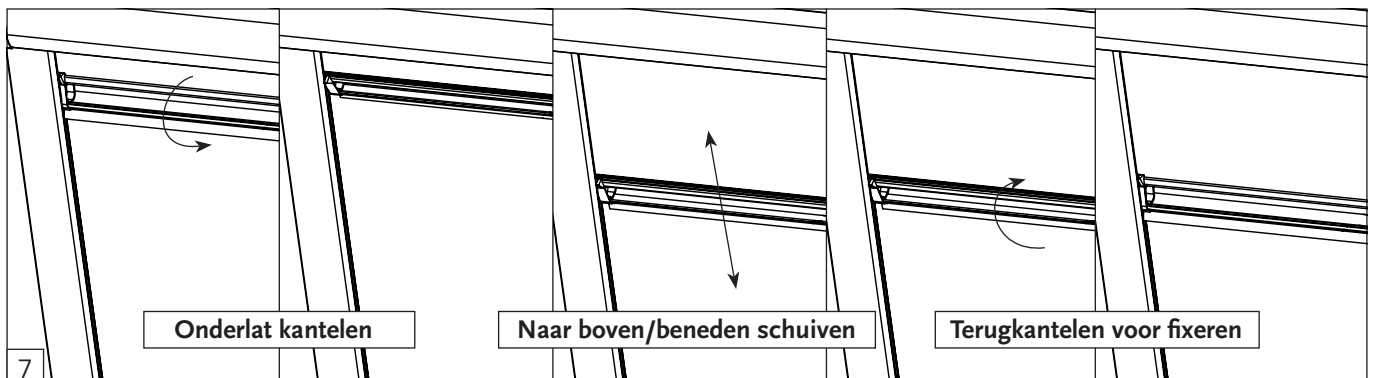

7